



FITTING INSTRUCTIONS FOR CR0035BK OFFSET COTTON REELS
KAWASAKI ZX10 2011



THIS KIT CONTAINS THE ITEMS PICTURED AND LABELLED BELOW.
DO NOT PROCEED UNTIL YOU ARE SURE ALL PARTS ARE PRESENT.

Please note that the way the kit is packed does not necessarily represent the way of mounting to the bike
THE PARTS SHOWN MAY BE REPRESENTATIVE ONLY (FOR CLARITY OF INSTRUCTIONS ONLY)

**LEFT HAND
SIDE**

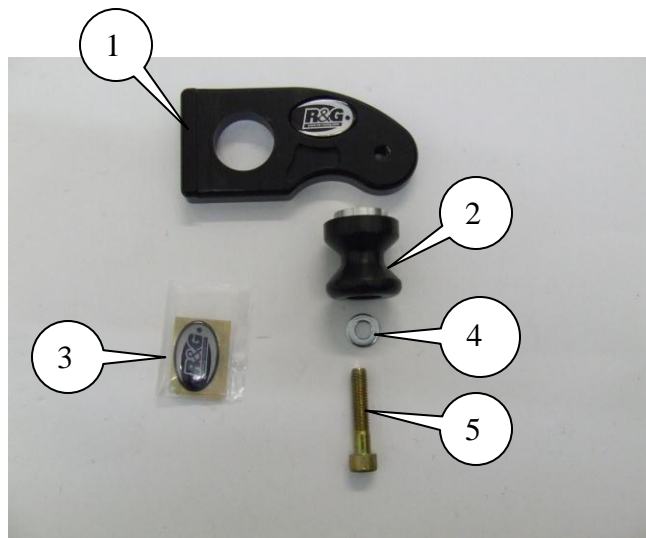



**RIGHT HAND
SIDE**

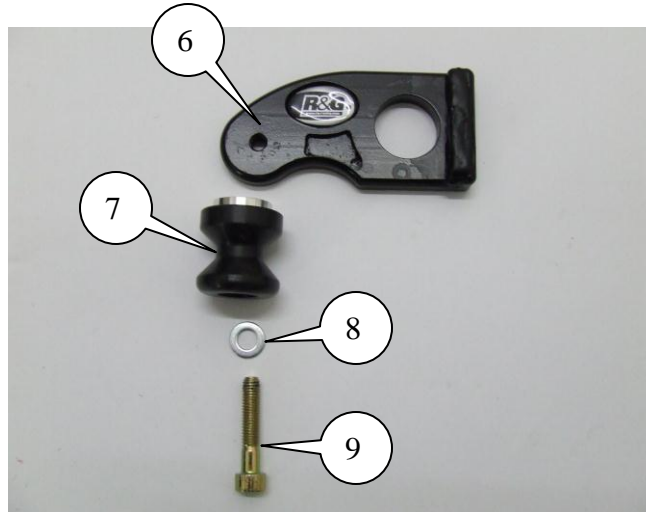

LEGEND

ITEM 1 = LEFT HAND SIDE REPLACEMENT ADJUSTER BLOCK/COTTON REEL MOUNT (x1) (M0268).

ITEM 2 = COTTON REEL (B0443) FITTED WITH COMPRESION SLEEVE (CS300) (x1).

ITEM 3 = BUBBLE STICKERS (RGS0005) (x6).

ITEM 4 = 8mm WASHERS 16mm OUTSIDE DIAMETER (x1).

ITEM 5 = M8x1.25x40mm LONG CAP HEAD BOLT (x1).

ITEM 6 = RIGHT HAND SIDE REPLACEMENT ADJUSTER BLOCK/COTTON REEL MOUNT (x1) (M0269).

ITEM 7 = COTTON REEL (B0443) FITTED WITH COMPRESION SLEEVE (CS300) (x1).

ITEM 8 = 8mm WASHERS 16mm OUTSIDE DIAMETER (x1).

ITEM 9 = M8x1.25x40mm LONG CAP HEAD BOLT (x1).

Please note that in cases where kits are packed with rubber washers holding the components onto the bolt – *the rubber washers should be thrown away!*

TOOLS REQUIRED

- 6mm A/F ALLEN KEY.
- 32mm A/F SOCKET AND WRENCH.
- TORQUE WRENCH TO BE USED AT 127Nm.
 - PADDOCK STAND.

FITTING INSTRUCTIONS

Please read all instructions before commencing fitting



- Raise rear of bike on original paddock stand bobbins, support rear wheel (suggest using blocks of wood) to prevent wheel from dropping when rear spindle is removed.
- Remove split pin.
- Undo the rear spindle nut.
- Remove the rear spindle.
- Remove the OEM chain adjuster blocks.
- Place the new right hand adjuster block/cotton reel mount (this is the adjuster block/cotton reel mount with the slot to accept the spindle head, it is the same thickness as the original adjuster block) onto the rear wheel spindle as original.
- Slide spindle through the swing arm, brake calliper and rear wheel.
- Place the remaining thicker adjuster block/cotton reel mount over the exposed spindle and into adjuster slot.
- Refit the spindle washer and nut and tighten according to the manufactures instructions (127Nm) and check chain adjustment.
- Refit the split pin.
- Fit the new cotton reels to the new adjuster blocks on both sides.
- Fit bubble stickers if not already fitted.
- Remove bike from the paddock stand.

ISSUE 1 24/02/2011 (NSY)

CONSUMER NOTICE

The catalogue description and any exhibition of samples are only broad indications of the Products and R&G may make design changes which do not diminish their performance or visual appeal and supplying them in such state shall conform to the order. The Buyer acknowledges no representation or warranty (other than as to title) has been given or will apply to the Products other than those in R&G's order or confirmation and the Buyer confirms it has chosen the Products as being of merchantable quality and suitable for its particular purposes. Where R&G fits the Products or undertakes other services it shall exercise reasonable skill and care and rectify any fault free of charge unless the workmanship has been disturbed. The Buyer is responsible for ensuring that the warranty on the motorcycle is not affected by the fitting of the Products. On return of any defective Products R&G shall at its option either supply a replacement or refund the purchase money but shall not be liable if the Products have been modified or used or maintained otherwise than in accordance with R&G's or manufacturer's instructions and good engineering practice or if the defect arises from accident or neglect. Other than identified above and subject to R&G not limiting its liability for causing death and personal injury, it shall not be liable for indirect or consequential loss and otherwise its liability shall be limited to the amounts paid by the Buyer for the Products or the fitting or service concerned. These terms do not affect the Buyer's statutory rights.

R&G RACING RETURNS POLICY (NON-FAULTY GOODS)

Returns must be pre-authorized (if not pre-authorized the return will be rejected). Goods may only be returned direct to us if they were purchased direct from us (customer must prove if necessary). Otherwise to be returned to original vendor. Goods must be in resellable condition, in the opinion of R&G Racing. All returns are subject to a 25% restocking and handling fee (25% of the gross value exc. P&P – at the prevailing price at time of purchase). The customer must pay any and all carriage charges. No returns of discontinued products, unless within 14 days of purchase. This policy does not affect your statutory rights and does not refer to faulty goods.



FRANCE
INSTRUCTIONS DE MONTAGE POUR LES DIABOLOS
CR0035BK KAWASAKI ZX10 2011

LA PRESENTATION DES PIECES R&G DANS L'EMBALLAGE N'EST PAS TOUJOURS IDENTIQUE AU SENS DE MONTAGE.

Merci de noter que dans le cas où les protections sont assemblées avec une bague en caoutchouc, merci de bien vouloir le retirer lors du montage des pièces sur la moto.

LEGENDE

- Art 1 = Support de diabolos/tendeur de chaine Gauche (x1) (M0268).
- Art 2 = Diabolos (B0443) (x1).
- Art 3 = Autocollants (RGS0005) (x6).
- Art 4 = Rondelles 8mm (Dia ext 16mm) (x1).
- Art 5 = Vis M8x1.25x40mm (x1).
- Art 6 = Support de diabolos/tendeur de chaine Droit (x1) (M0269).
- Art 7 = Diabolos (B0443) (x1).
- Art 8 = Rondelles 8mm (Dia ext 16mm) (x1).
- Art 9 = Vis M8x1.25x40mm (x1).

OUTILS NECESSAIRE

- Clef Allen de 6mm .
- Clef à douille de 32mm.
- Clef Dynamométrique (jusque 127Nm).
- Béquille de stand.

INSTRUCTIONS DE MONTAGE

MERCI DE LIRE LA NOTICE AVANT DE COMMENCER LE MONTAGE DES PIECES.

- Levez l'arrière de la moto en utilisant une béquille de stand (utilisez les tampons d'origine), placez une cale en bois (ou autre) pour maintenir la roue en position ceci afin d'éviter que celle-ci ne bouge pendant le montage.
- Enlevez la goupille située sur l'écrou de l'axe.
- Desserrez l'écrou de l'axe de roue arrière.
- Enlevez l'axe de roue.
- Enlever les tendeurs de chaîne d'origine.
- Placez le nouveau tendeur côté droit, (il s'agit du modèle pouvant absorber la tête de l'axe de roue- Attention au sens de montage) sur l'axe de roue arrière.
- Glissez l'axe et le tendeur R&G à travers le bras oscillant, le support de frein arrière et à travers la roue.
- Placez le tendeur de chaine restant sur l'axe contre le bras oscillant côté gauche. (Attention au sens de montage).



- Glissez la rondelle de l'axe de roue, puis vissez l'écrou d'origine. (couple de serrage recommandé 127 Nm). Puis vérifiez la tension de la chaîne.
- Remplacez la goupille sur l'axe.
- Fixez les diabolos R&G sur les tendeurs R&G (à l'aide des vis fournies dans le kit).
- Placez les autocollants
- Enlevez la béquille de stand.